

Series 550 LP and 560 HP

Manual Dispense Valve



The inexpensive Series 550 LP (shown at right) and 560 HP Valves are intended for low pressure and high pressure meter mix applications, respectively. These manual valves are ideal for dispensing beads or RTM casting. The design is simple: two ball valves are threaded into the back of the manifold and are connected to a common lever so that both valves open and close at the same time.

(The 550 LP Valve is not intended for “feathering” or otherwise attempting to meter the flow.)

Specifications

- Material Inlet: 1/4" FNPT
- Weight:
 - 550 Valve: 2.5 lbs (1.1 kg)
 - 560 Valve: 1,500 psi (103 bar)
- Pressure Rating:
 - 550 Valve: 600 psi (41 bar)
 - 560 Valve: 1,500 psi (103 bar)
- Wetted Parts:
 - 550 Valve: Brass, Aluminum, and Carbon Steel
 - 560 Valve: 303 SS

Part #	Description	Style	Material
7702511	Valve w/Series 160 Outlet	High Flow	Brass / Alum. / CS
7702515	Valve w/Series 160 Outlet	Low Flow	Brass / Alum. / CS
7702492	Solvent Flush Check Valve	-	Brass
7702494	Solvent Flush Check Valve	-	Stainless Steel



Series 160 Mixers

- Specifications
 - Element: Polyplas™
 - Housing: Polypropylene
- Accessories
 - Dispensing Tips
 - Manifold
 - Night Cap and Ratio Check Cap
 - One-Piece Jacket Pipe Adapter
 - Retaining Nut

Options

- Low Flow
- High Flow
- Wide Ratio



more info

Series 550 LP Dispense Gun

(Brass, Aluminum & Carbon Steel Wetted Parts)

Maximum Working Pressure: 600 psi (40 bars)

Ref. #	Qty.	Part #	Description
1	1	7702522	Hand Grip
2	2	7702525	1/4" MNPT Plug (CS)
3A	1	7702526	Series 160 (A1) Manifold-LF
3B	1	7702527	Series 160 (A1) Manifold-HF
3C	1	7702528	Series 160 (A1) Manifold-DR
4	2	7702538	1/4" Swivel Connector (CS)
5	2	7702529	ON/Off Ball Valve (Brass)
6	1	7702539	One Pc. A1. Yoke Assembly*
7	1	7702533	Handle

Accessory A: Solvent Flush Check: Valve, Brass,
Part # 7702492, 7702494

Accessory C: Ratio Check cap,
Part # 7701184

Accessory D: Night Cap,
Part # 7701181

* Includes Set Screws

Manifold Selection/ Orifice style

Low Flow-LF: 3A

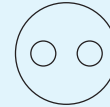

High Flow-HF: 3B & 3E

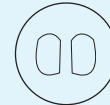

Different ratio-DR: 3C

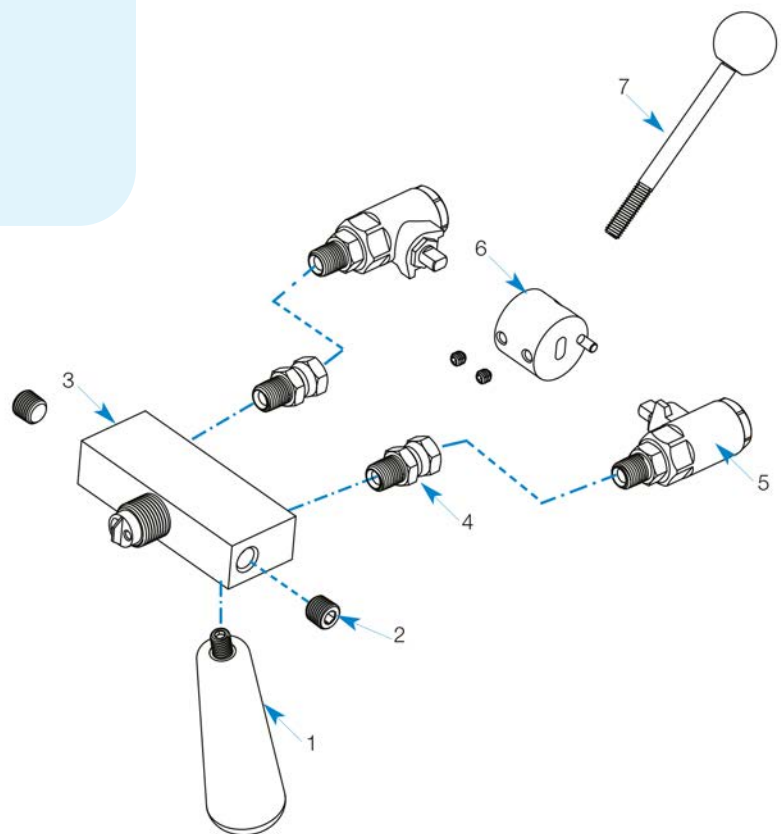
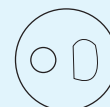

Series 560 LP Gun (Stainless Steel)

(All Stainless Steel Wetted Parts)

Maximum Working Pressure: 1500 psi (100 bars)

**Manifold Selection/
Orifice style**

High Flow-HF: 3

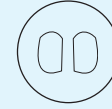

Ref. #	Qty.	Part #	Description
1	1	7702522	Hand Grip
2	2	7702554	1/4" MNPT Plug (CS)
3	1	7702565	1/2" MNPT (SS) Manifold-HF
5	2	7702529	ON/Off Ball Valve (Brass)
6	1	7702539	One Pc. A1. Yoke Assembly*
7	1	7702533	Handle

Accessory A: Solvent Flush Check: Valve, Brass,
Part # 7702492, 7702494

Accessory C: Ratio Check cap,
Part # 7701184

Accessory D: Night Cap,
Part # 7701181

* Includes Set Screws

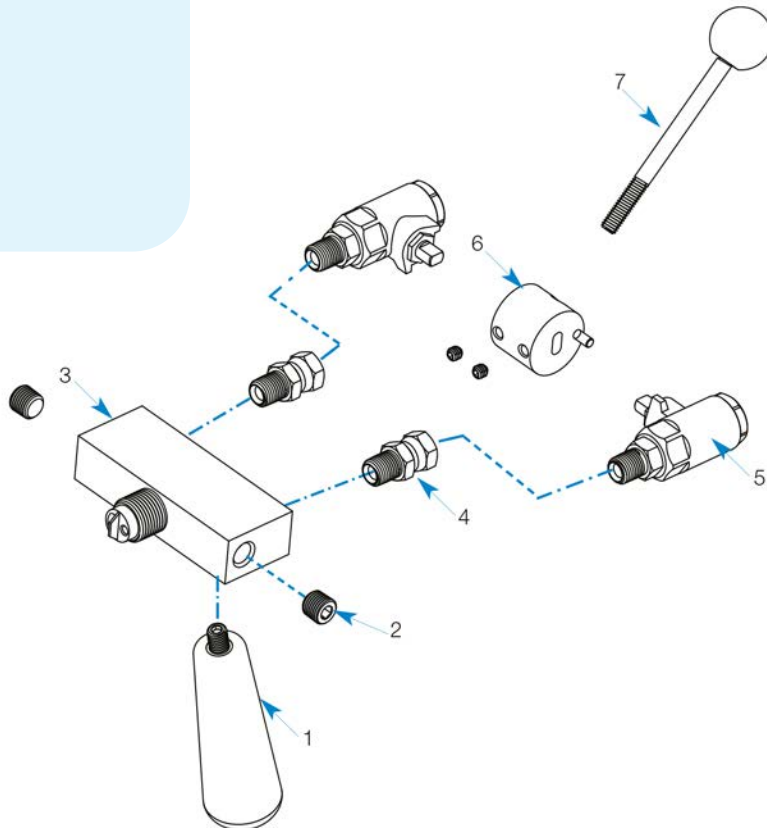



For Nordson EFD sales and service in over 40 countries, contact Nordson EFD or go to www.nordsonefd.com.

Global

800-556-3484; +1-401-431-7000
info@nordsonefd.com

Europe

00800 7001 7001
infoefd.europe@nordsonefd.com

Asia

China: +86 (21) 3866 9006; china@nordsonefd.com
India: +91 80 4021 3600; india@nordsonefd.com
Japan: +81 03 5762 2760; japan@nordsonefd.com
Korea: +82-31-736-8321; korea@nordsonefd.com
SEAsia: +65 6796 9522; sin-mal@nordsonefd.com